

Thank you for using Digital Video Recorder!

Instructions:

This manual may contain technical inaccuracies or typographical errors, it will be updated regularly without notice; Updated contents will be added to the new edition of this manual. Products and software are subject to change or update , please Take the manual as reference.

Safeguards and Warnings:

- ◆ The following is about the correct use of products and methods for prevention of dangerous, to prevent the loss of property and other content, when in use, please be sure to comply with.
- ◆ Please place and use this product in 0°C - 55°C , and don't put it in a humid environment.
- ◆ Please do not put it in direct sunlight or near the heating equipment.
- ◆ Don't install it in the wet, dirty or sooty places.
- ◆ Please keep this product horizontal installation.
- ◆ Please install it in a stable place, to avoid this product's falling.
- ◆ Do not put other equipments on the product.
- ◆ Please install in a well-ventilated place, do not jam the vents.
- ◆ Only available in the rated input and output range.
- ◆ Please do not disassemble the product casually.

Contents

| | |
|--|-------------|
| Preparation | 3 |
| 1.1 Unpacking Check..... | 3 |
| 1.2 Installation of hard disk..... | 3 |
| 1.3 Instruction of Front panel | 錯誤! 尚未定義書籤。 |
| 1.4 Instruction of the rear panel | 錯誤! 尚未定義書籤。 |
| 1.5 Instructions of alarm connection | 錯誤! 尚未定義書籤。 |
| 1.5.1 Instructions of alarm input..... | 錯誤! 尚未定義書籤。 |
| 1.5.2 Instructions of alarm output | 錯誤! 尚未定義書籤。 |
| 1.5.3 Connection method between PTZ and DVR..... | 錯誤! 尚未定義書籤。 |
| 1.6 DVR connections diagram | 9 |
| Basic Operation..... | 10 |
| 2.1 Power on..... | 10 |
| 2.2 Power off | 10 |
| 2.3 Login | 10 |
| 2.4 Preview | 10 |
| 2.5 Enter menu | 11 |
| 2.6 Record setting..... | 11 |
| 2.7 Record..... | 12 |
| 2.8 Video Playback..... | 13 |
| 2.9 Network Setting | 15 |
| 2.10 PTZ settings | 15 |
| 2.11 Menu Structure..... | 18 |
| Announce | 19 |

The network digital video recorder specialized in video surveillance applications, with the standard H.264 Main Profile and standard network video communication protocol, It is the new generation standalone digital video recorder product, and the main characteristic is to satisfy network, intelligence in the new stage of requirements, to provide higher, stronger performance and be friendly in the man-machine interface, which can meet the needs of individuation and standardization. Network DVR can be widely used in financial, public security, shops, family and other fields of safety.

Preparation

1.1 Unpacking Check

When the shipping company sends you the DVR, firstly please check its appearance whether there are any obvious damages. The selection of protection materials on product packaging can handle most of the accident crash in transportation. And then please open the case, to be sure that parts are all ready.

1.2 Installation of hard disk

SATA hard drive (1 U machine) installation steps:

Installation tools: Cross screwdriver

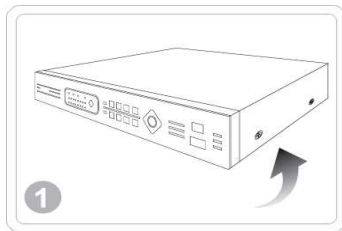

□ Remove the screws on both sides

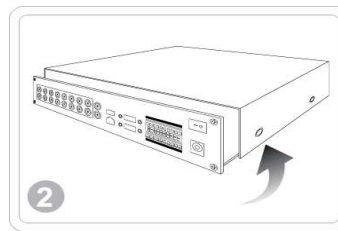

□ Remove case

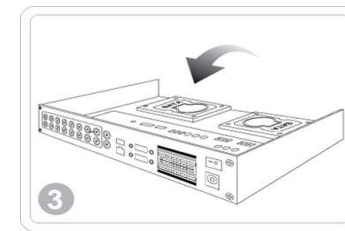

□ Install the hard drive to HDD base

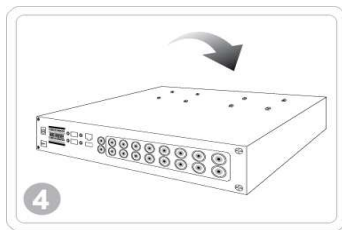

□ Fix the screws at the bottom

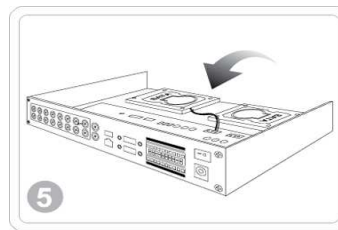

□ Plug hard disk data and the power cord in



□ When installing the upper cover, please

aim at the front panel first aim at the front
end first

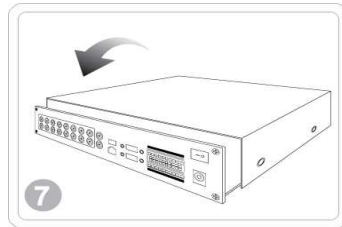

□ Install rear-panel

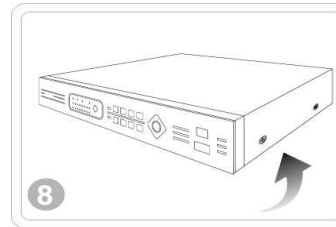

□ Put it in right position and fix the screws on
the casing

SATA hard drive (1.5/2 U machine) installation steps:

Installation tools: Cross-screwdriver

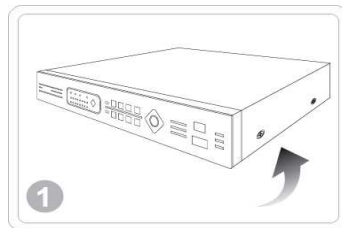

□ Remove the screws on both sides

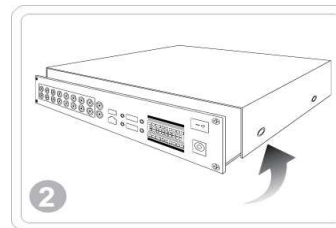

□ Remove the case, see the HDD bracket

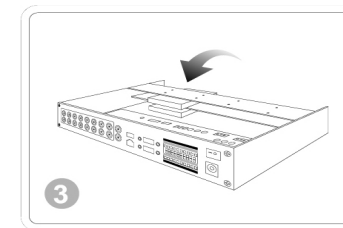

□ Aim the hard disk at four holes of Hard
disk stents

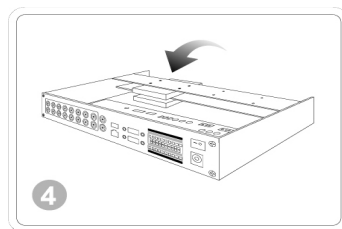

□ Use screws to fix the hard disk on the

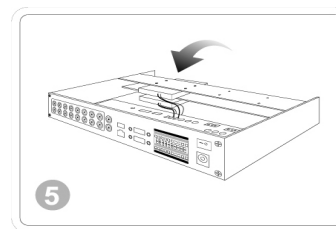

□ Plug the hard disk data and the power cord



□ When installing the upper cover, please

bracket



□ Install rear panel

in

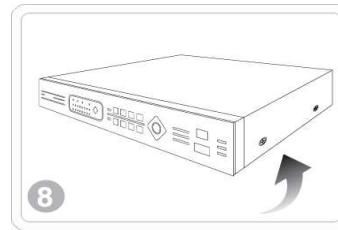

□ Put it at right position and fix the screws on the casing

aim at the front panel first

Precautions:

- 1.Ensure that the environment temperature is below 35 °C (95 °F).
 - 2.Keep 15 centimeters (6 inches) space in airiness around this equipment.
 - 3.Please install case from bottom to up.
 - 4.If there is multi equipments on the shelf , make sure the power supply is not overlayed
- Check the hard disk when in first use, hard disk amount is subject to the SATA port amount on the mainboard.

Attention:

- 1.After you install the hard disk, our equipment will format your hard disk automatically.
 - 2.Attention in buying : It is strongly recommended that you try to use the DVR dedicated hard disk ,which can work for a long period of time in frequently read/write condition.
- Please buy this hard disk though official channel for quality assurance.

1.3 Front panel

Front panel diagram, please mainly in kind.



| No. | Function | Function Description |
|-----|----------------------------------|--|
| 1 | Power switch | Running in the system directly boot software shutdown, and software |
| 2 | USB | U disk upgrade or mouse and other USB devices |
| 3 | Remote Control Receiver Terminal | Aligned using a remote control, remote control can operate |
| 4 | Power/Net/Rec/Alarm/run | Power: Red lights for the start-state Alarm: Long bright When an alarm; Rec:A hard light, bad hard drive / flash failure; Net:IP conflict, cable light flashes Run:running |
| 5 | DVD RW | DVD writer |
| 6 | Arrow keys | select the menu option; Up and down keys: to change the settings options or numerical size; preview screen to switch; Left and right keys: switch the selected controls; |
| 7 | Number keys | Form 1 to 16: Single amplification channel selection screen |
| 8 | Function Keys | MENU ESC FN PTZ REC PLAY PRE PAUSE NEXT STOP MODE MUTE |
| 9 | Jog dial | Video playback, select the upper and lower a video |

1.4 Rear panel

4-CH rear panel diagram schematic, please mainly in kind

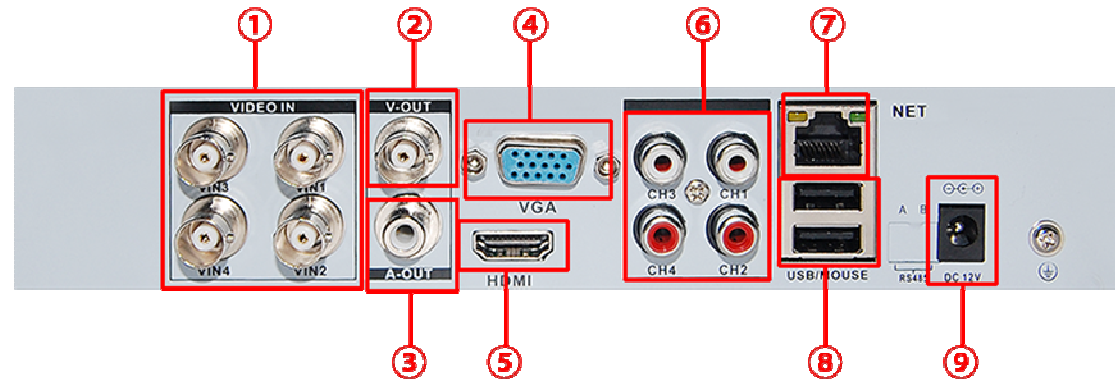

| | | |
|----------|-------------------|--|
| Number 1 | video input | composite video signal (CVBS) input interface |
| Number 2 | video output | composite video signal (CVBS) output interface |
| Number 3 | audio output | composite audio signal output interface |
| Number 4 | VGA interface | VGA video signal output interface |
| Number 5 | HDMI interface | HDMI video signal output interface |
| Number 6 | audio input | interface of the input audio signal |
| Number 7 | network interface | RJ-45 network interface |
| Number 8 | USB interface | USB interface |
| Number 9 | Power Input | 12V DC power input interface |

1.5 DVR connections diagram

Take a 4CH DVR as e.g.

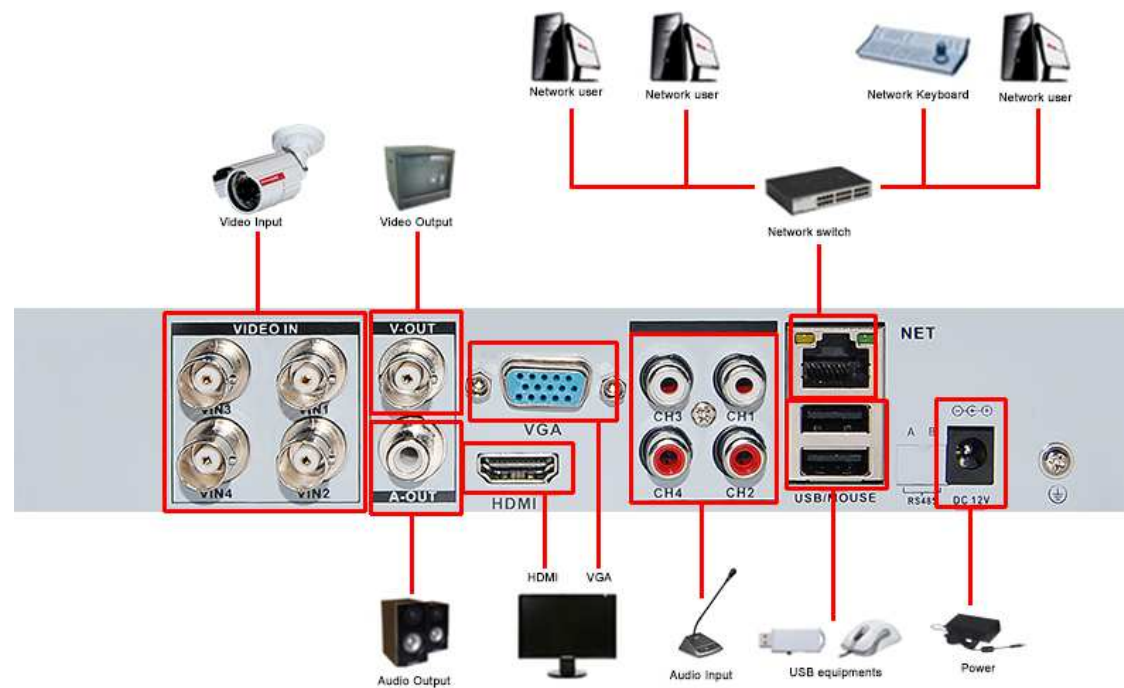

Basic Operation

2.1 Power on

Warning: please make sure DVR is connected to a correct power supply and a monitor ,otherwise user can't enter the system.

Press the [Power] on the front panel to start the equipment.

2.2 Power off

Warning: Unstable power supply will cause damage to the DVR, please make sure the power supply is stable at your place, otherwise please use a regulated power supply to the DVR.

1、 Normal Shutdown

Method 1: Enter the equipment shutdown interface [Main Menu]> [System Management]> [Shutdown],select [Shutdown].

Method 2: Press [Power] of the front panel more than four seconds, otherwise it can not shut down.

Method 3: Press [Power] of remote control.

2、 Forced shutdown

Turn the power button off or pull the power cord out: Try to avoid forced shutdown the system when the DVR is running(especially at recording).

2.3 Login

After equipment starts normally, you need log in the system, which provides corresponding functions according to user authority.

Note: One preset administrator account exists, username is admin, password is 12345,user can change password, but can not change the authorities. Administrator can add, delete or config user parameter.



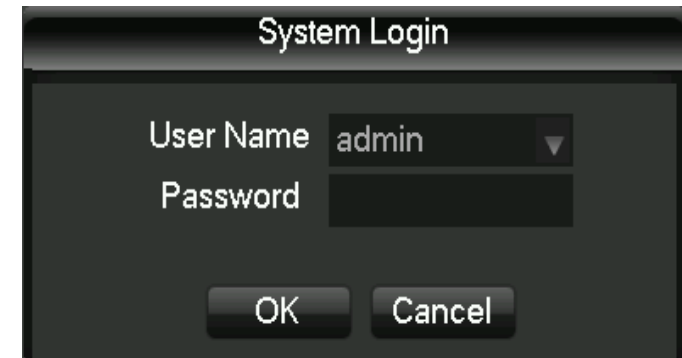

Password protection: An alarm beep popup when password was inputed incorrectly for continuous 3 times, and system will be locked after password was inputed incorrectly for continuous 5 times. After 30 minutes or reboot the DVR system will be unlocked by itself. For security, the password should be modified as soon as your first using the DVR.



Login

2.4 Preview

After normally log in, display the multi preview. In preview, it shows date, time, channel name, record and alarm status.

| | | | |
|---|-------------------------------|--|--------------------------------|
|  | Channel record sign |  | Channel roundrobin switch sign |
|  | Channel motion detection sign |  | Channel audio switch sign |
|  | Video missing | | |

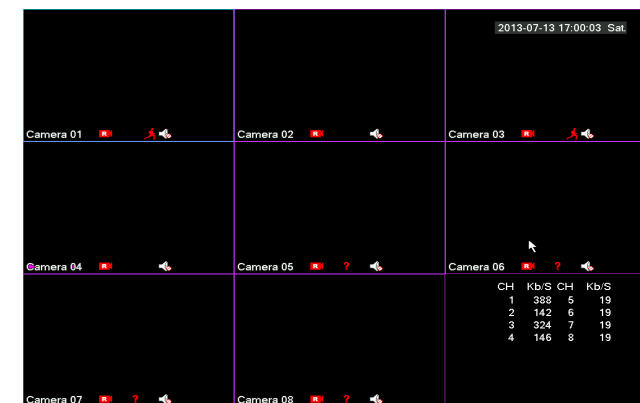

Preview

2.5 Enter menu

In main preview, Left-click mouse or select [Main menu] at Right-click mouse button to enter menu. The function of main Menu is to config, manage and operate the system.



Main Menu

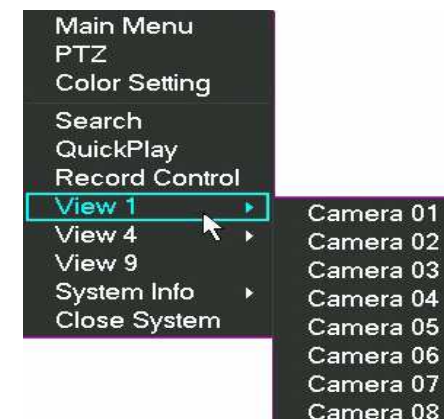

Right-click Menu

2.6 Record setting

Set record parameter, press [Main Menu]> [Configuration]> [Record]> [Record Plan]

System defaults to 24 hours sequence record.

[Channel]: Select corresponding channel number to setting.

[Prerecord]: Record 1-30 seconds before record action condition (time span may change because of bit stream).

[Redundance]: Backup videotape to two hard disks. one disk is read-write disk, another is redundance disk.

[Week]: set time quantum of recording, only in setting time, you can start recording. Set corresponding week, it provides six quantum. If set for all, please select "All".

[Timing]: Set time section of recording, only in setting time, you can start recording. Set corresponding week, it provides six quantum.

[Record type]: Set record type, three types : regular, motion detection, alarm.

Note: Regular: Perform the regular recording in the set time section. The video file type is "R".

MD: Trigger the "Motion detect", "camera mask" or "video loss" signal. When above alarm is set as opening recording, the "detection recording" state is on. The video file type is "M".

Alarm: Trigger the external alarm signal in the set time section. When above alarm is set as opening recording, the "detection recording" state is on. The video file type is "A".

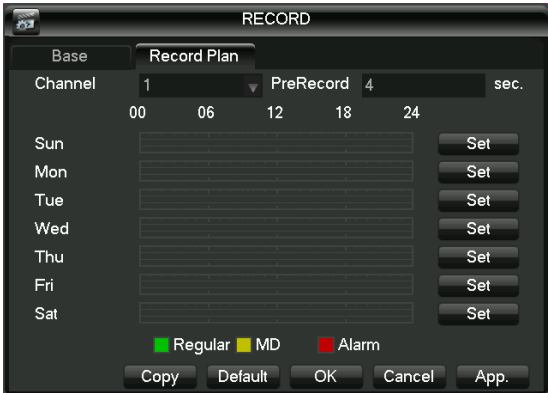

Schedule interface

2.7 Record

Note: manual video operation calls for user operation right. please make sure you have installed disk before it.

From [Shortcut Menu]> [Record] > [Manual Record]

[Channel]: list all channels number, the number is the same as the biggest path.

[State]: list all channels condition, have three condition, automatic , manual, close. the corresponding channel shows

“  ”.

Manual : Select one or more path to start recording, priority is most, no matter what condition, press manual button, all channels are normal records.

Automatic: record is based on record setting (fixed time, dynamic check, alarm)

Stop: Select one or more path close record.



Record

2.8 Video Playback

From [Shortcut Menu]> [search], go into the playback interface.

Note : Normal playback, storage equipment of hard disk video files should be set to reading and writing the disk or read-only disk.

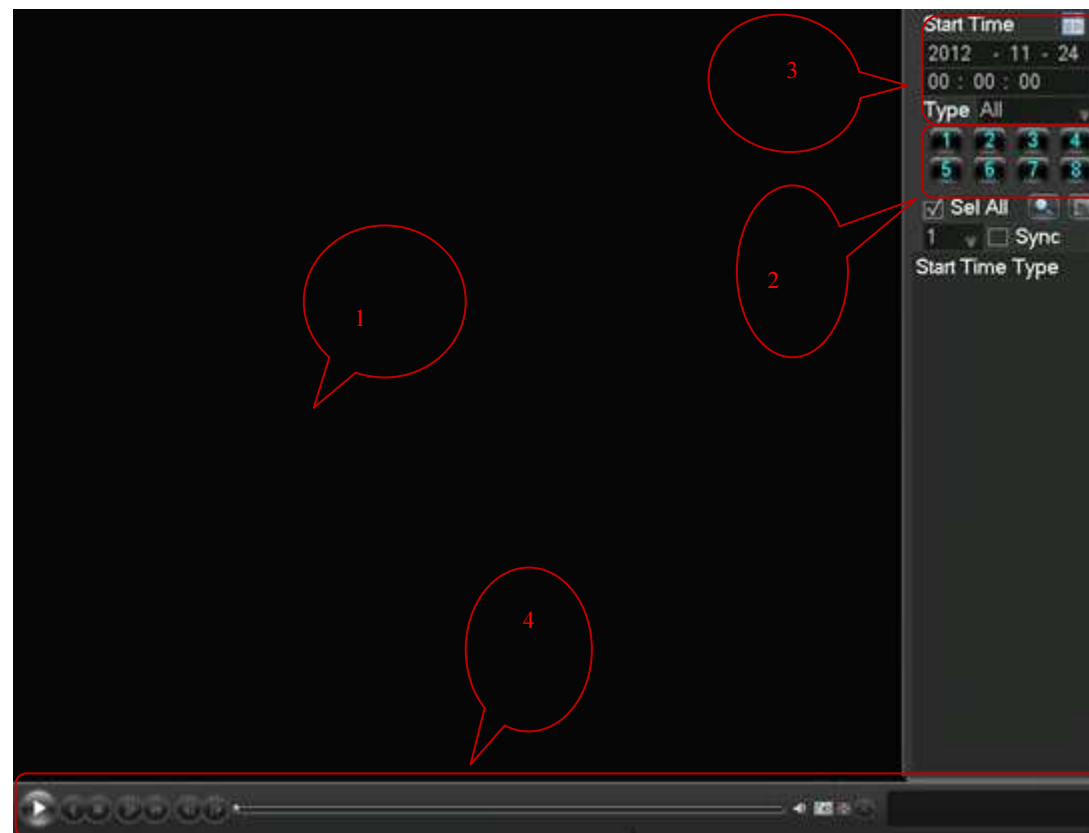











Video playback interface

Instructions of the player:

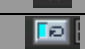
| Number | Name | Instructions |
|--------|-------------------|--|
| 1 | Playback area | Video playback area can show single channel or more channels |
| 2 | Channel number | Video channel Numbers |
| 3 | Video information | Video information including the starting time and type |
| 4 | The toolbar | Play control bar, including play/pause, backup, inquires the and so on |

Player toolbar instructions:

| Button | Instructions |
|---|--|
|  | Play/pause key |
|  | Every time you play this backwards, back 2 seconds |
|  | Closed |
|  | Quick play keys, support four times as much as quick put |
|  | Slow play key , support four times slow play |
|  | Play next frame, to be suspended state |
|  | Play prior frame, to be suspended state |
|  | Voice |
|  | Circulation play |
|  | Full-screen |
|  | Show video type |

Special features:

Digital zoom in preview and playback: When single screen preview or playback in full screen ,can press the left key of mouse to choose any size area in screen picture, click the left key of mouse in the chosen area, can zoom images broadcast this area, click the right button of mouse to exit partial enlargement picture.

2.9 Network Setting

Configuration preparation

Before configuration preparation of the network , please confirm whether IP equipment have been connected to the network equipment firstly,and configure the equipment network.

From [Main menu] > [Configuration]> [Network], enter the setup interface.

Note:If a network in a DHCP server can be checked, "automatic get IP address" can take effect. Otherwise,the user can allocation network IP, subnet mask,gateway and DNS according to the demand.If a network in a DHCP server can be checked, "automatic get IP address"can take effect.Otherwise,the user can allocation network IP,subnet mask, gateway and DNS according to the demand.

[NIC]: Users can choose f different network adapter according to the different needs.

[IP address]: Set the IP address of the equipment, the default IP address: 192.168.1.88.

[Subnet mask]:Setting equipment subnet mask, the default subnet mask: 255.255.255.0.

[Default gateway]: Set the default gateway equipment, the default gateway: 192.168.1.1.

[DNS Settings]: DNS server, used for domain name system into IP address, this address in provided by your network operator.

[Maximum number of connections]: The biggest client and a WEB connection number, the default to 10.

[TCP port]: The default for 8000.

[UDP port]: The default for 8001.

[HTTP port]:The default for 80.""

[UPNP]: [Main menu] > [Configuration]> [Network] > [Advanced]> [Multicast setting], after enable the "UPNP port mapping",then can be used.

2.10 PTZ settings

Through the following steps,can manipulate simple of PTZ.

Step one: In [Main menu]> [output], set channels, protocols and other basic parameters.

Step two: From [Shortcut Menu] > [PTZ], enter to the single window for PTZ control.

[Speed]: Set the head rotation amplitude, the larger the number, the greater the range, setting range: 1 to 8.

[Zoom]: Click - / + button to adjust the zoom multiple of the camera.

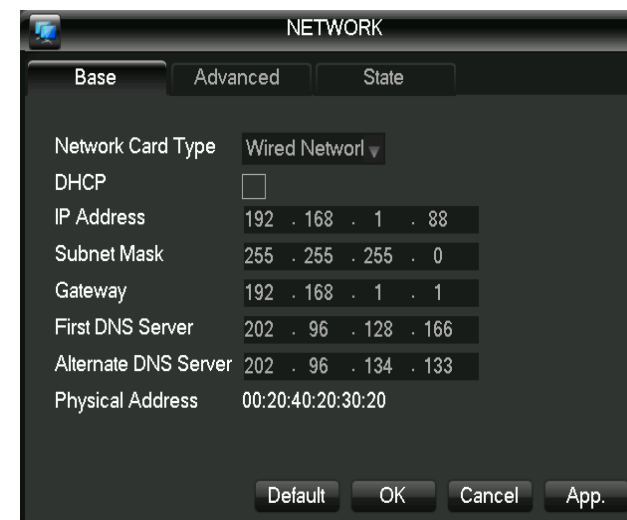

Network Settings



PTZ Control

[Focus]: Click - / + button to adjust the focus of the camera.

[Iris]: Click - / + button to adjust the iris of the camera.

[The direction key control]: Control the PTZ rotation. 8 directions control is supportive. (4 directions in Front panel is supportive)

[Set]: Enter the function operation menu.

2.11 Menu Structure

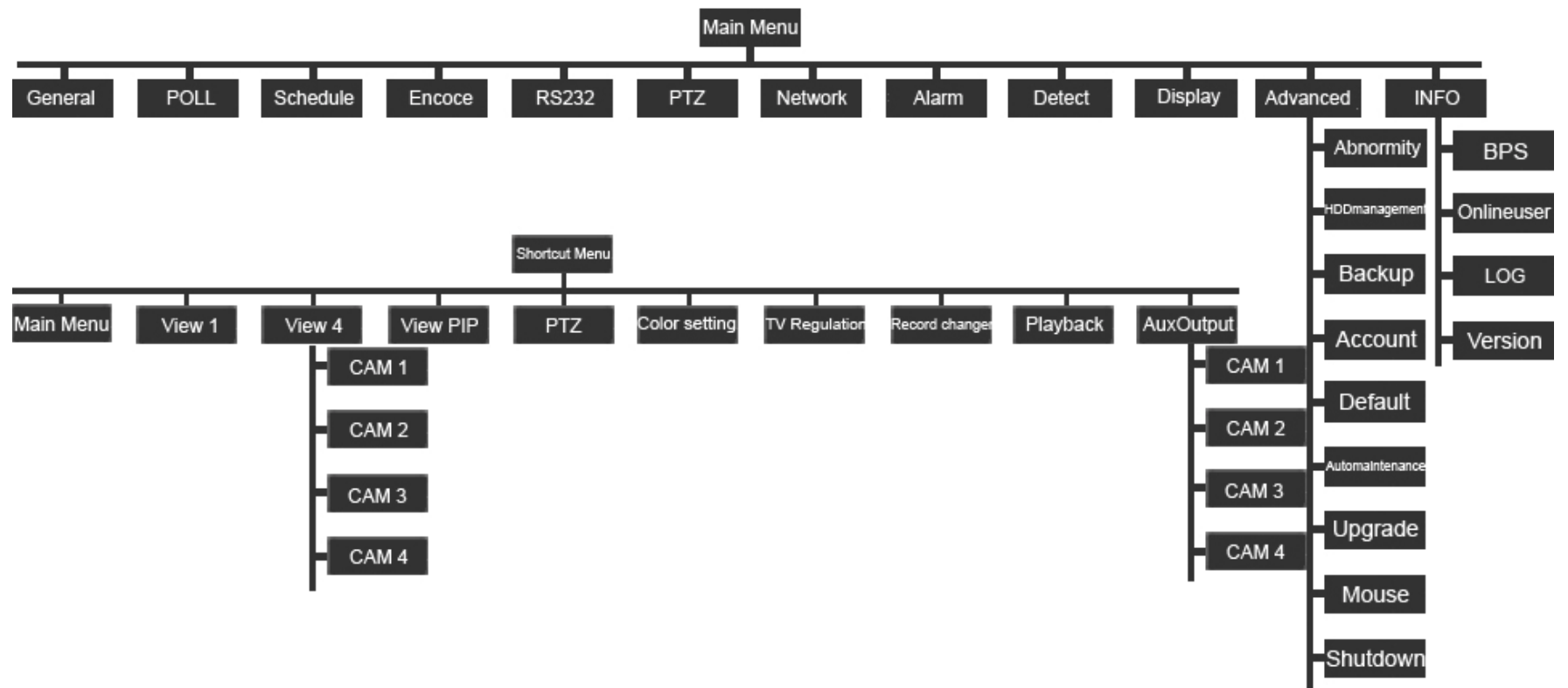

Announce

- This manual only introduces basic operation, specific operation refer to E-manual in CD.
- If Product description has problem, it is subject to our company explanation.
- This manual adapts to different types, every specific operation can not list, please contact custom service if having problems.